



Borough of Madison
Hartley Dodge Memorial
50 Kings Road
Madison, NJ 07940

Property Assessor
o: 973-593-3067
E: cardinij@rosenet.org
w: rosenet.org

Via Email Only: dana@hofmannndb.com

January 27, 2023

Dana Napurano , AIA
Hofmann Design Build
365 South St, #101
Morristown, NJ 07960

Re: 200' List – 30 Knollwood Avenue, 905/17

Attached, please find a certified list of names and addresses of property owners from the most recent tax rolls of the Borough of Madison within the 200-foot radius of the above referenced property. They must be given notice pursuant to the requirements of N.J.S.A. 40:55D – 7.1. This list is valid for 60 days.

A list of utility companies listed in the Borough of Madison is also enclosed.

Should you have any questions, please do not hesitate to call or email.

Sincerely,

Jacqueline Cardini
Borough of Madison
Assessor

Payment Date: 1/27/23

Payment Type:

Cash



Borough of Madison
Hartley Dodge Memorial
50 Kings Road
Madison, NJ 07940

Property Assessor
o: 973-593-3067
E: cardinij@rosenet.org
w: rosenet.org

In accordance with state law you must notify the following utility companies listed in the Borough of Madison

Electric/Water Madison Electric/Water Department
 Hartley Dodge Memorial
 50 Kings Road
 Madison, New Jersey 07940

Gas Public Service Electric and Gas Company
 Manager – Corporate Properties
 80 Park Plaza, T6B
 Newark, New Jersey 07102

Telephone Verizon of New Jersey – Highlands
 Paul Grosso, ROW Department
 290 W. Mt. Pleasant Avenue – Room 40D2
 Livingston, New Jersey 07039

Cable Cablevision of Morris
 Hollis Orderson, Engineering Department
 683 Route 10 East
 Randolph, New Jersey 07869-3799

If the property is adjacent a County Road, legal notice must be sent to the following:

Morris County Planning Board
P.O. Box 900
Morristown, New Jersey 07963

If the property is adjacent to a State Highway, legal notice must be sent to the following:

N.J.D.O.T.
1035 Parkway Avenue
CN 600
Trenton, New Jersey 08625

Important Note: If the property is within 200' of an adjoining municipality, legal notice must also be sent via certified mail to the Municipal Clerk of that adjoining municipality. A 200' list of property owners must also be obtained and notified.

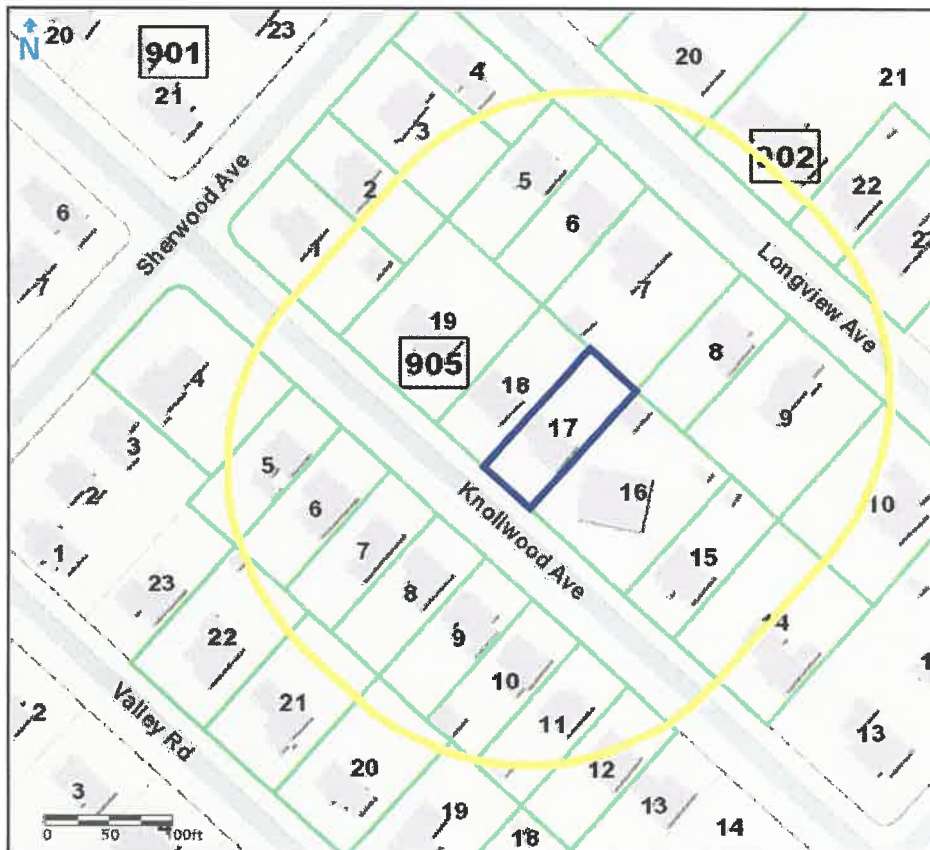

Morris County Board of Taxation
 COUNTY OF MORRIS, NEW JERSEY
 P.O. Box 900, Morristown NJ, 07963-0900
 *Maximum of 500 records available on report

Projection: State Plane (FIPS 2900)
 Datum: NAD83
 Units: Feet

Morris County GIS Services, NJ, USA - © 2011-2016

The maps and data available for access at this website is provided "as-is" without warranty or any representation of accuracy, timeliness, or completeness. The burden for determining accuracy, completeness, timeliness, merchantability and fitness for, or the appropriateness for use, rests solely on the user accessing this information. The County of Morris makes no warranties, express or implied, as to the use of the maps and data available for access at this website. There are no implied warranties of merchantability or fitness for a particular purpose. The user acknowledges and accepts all inherent limitations of the maps and data, including the fact that the maps and data are dynamic and in a constant state of maintenance, correction, and revision. The maps and associated data at this website do not represent a survey. In no event shall the County of Morris or its officers or employees assume any liability for the accuracy of the data delineated on any map. In no event shall the County of Morris or its officers or employees be liable for any damages arising in any way out of the use of this information.

| TARGETED PROPERTIES: | | | | |
|----------------------|--------|-------------------|------------------------------------|---------------------------------------|
| PAMS_PIN | Acres | Property Location | Owners Name | Mailing Address |
| 1417_905_17 | 0.1435 | 30 KNOLLWOOD AVE | FERRIE, MICHAEL & MURPHY, JENNIFER | 30 KNOLLWOOD AVE MADISON, NJ 07940 |

OWNER & ADDRESS REPORT

MADISON BOROUGH

01/27/23 Page 1 of 2

| BLOCK | LOT | QUAL | CLA | PROPERTY OWNER | PROPERTY LOCATION | Add'l Lots |
|-------|-----|------|-----|--|-------------------|------------|
| 905 | 17 | | 2 | FERRIE, MICHAEL & MURPHY, JENNIFER 30 KNOLLWOOD AVE MADISON, NJ 07940 | 30 KNOLLWOOD AVE | |
| 902 | 20 | | 2 | CAINE, TIMOTHY HAROLD & COURTENEY L 39 LONGVIEW AVE MADISON, NJ 07940 | 39 LONGVIEW AVE | |
| 902 | 21 | | 2 | LEE, KEVIN R & EVANGELINE B. 35 LONGVIEW AVE MADISON, NJ 07940 | 35 LONGVIEW AVE | |
| 902 | 22 | | 2 | STOFIK, ANNA D. (LIFE ESTATE) 31 LONGVIEW AVE MADISON, NJ 07940 | 31 LONGVIEW AVE | |
| 902 | 23 | | 2 | NOLLKAMPER, MICHAEL/LINDA 29 LONGVIEW AVE MADISON, NJ 07940 | 29 LONGVIEW AVE | |
| 905 | 1 | | 2 | KELLEHER, THOMAS & MADELINE 24 KNOLLWOOD AVE MADISON, NJ 07940 | 24 KNOLLWOOD AVE | |
| 905 | 2 | | 2 | SCHAFFER, COREY & SAMANTHA SPADA 25 SHERWOOD AVE MADISON, NJ 07940 | 25 SHERWOOD AVE | |
| 905 | 3 | | 2 | WILSON, JOHN & MARY 27 SHERWOOD AVE MADISON, NJ 07940 | 27 SHERWOOD AVE | |
| 905 | 4 | | 2 | BOCCHINO, THERESA Y 31 SHERWOOD AVE MADISON, NJ 07940 | 31 SHERWOOD AVE | |
| 905 | 5 | | 2 | PASTRO, JAMES ANTHONY 40 LONGVIEW AVE MADISON, NJ 07940 | 40 LONGVIEW AVE | |
| 905 | 6 | | 2 | KINGMAN, DAVID L & NANCY P 38 LONGVIEW AVE MADISON, NJ 07940 | 38 LONGVIEW AVE | |
| 905 | 7 | | 2 | ROBINSON, DONALD L 36 LONGVIEW AVE MADISON, NJ 07940 | 36 LONGVIEW AVE | |
| 905 | 8 | | 2 | DALY, PAUL/DIANA 32 LONGVIEW AVE MADISON, NJ 07940 | 32 LONGVIEW AVE | |
| 905 | 9 | | 2 | NASTRO, TIMOTHY & ERIN 30 LONGVIEW AVE MADISON, NJ 07940 | 30 LONGVIEW AVE | |
| 905 | 10 | | 2 | SANFORD, PATRICIA S 26 LONGVIEW AVE MADISON, NJ 07940 | 26 LONGVIEW AVE | |
| 905 | 14 | | 2 | HELFRICH, GEORGE E & TARA J 42 KNOLLWOOD AVE MADISON, NJ 07940 | 42 KNOLLWOOD AVE | |
| 905 | 15 | | 2 | GOBES, MICHAEL & DEFRANCESCO, ELENA 38 KNOLLWOOD AVE MADISON, NJ 07940 | 38 KNOLLWOOD AVE | |
| 905 | 16 | | 2 | DONATI, JOSEPH M & ELLEN K 32 KNOLLWOOD AVE MADISON, NJ 07940 | 32 KNOLLWOOD AVE | |
| 905 | 18 | | 2 | OZOL, MICHAEL & STACY 28 KNOLLWOOD AVE MADISON, NJ 07940 | 28 KNOLLWOOD AVE | |

OWNER & ADDRESS REPORT

MADISON BOROUGH

01/27/23 Page 2 of 2

| BLOCK | LOT | QUAL | CLA | PROPERTY OWNER | PROPERTY LOCATION | Add'l Lots |
|-------|-----|------|-----|---|-------------------|------------|
| 905 | 19 | | 2 | NG, HERNAN & FEE, EILEEN C 26 KNOLLWOOD AVE MADISON, NJ 07940 | 26 KNOLLWOOD AVE | |
| 908 | 4 | | 2 | WIELANDY, STEPHAN & RAI A 19 SHERWOOD AVE MADISON, NJ 07940 | 19 SHERWOOD AVE | |
| 908 | 5 | | 2 | GIANCAMILLO, JOHN/JANE 23 KNOLLWOOD AVE MADISON, NJ 07940 | 23 KNOLLWOOD AVE | |
| 908 | 6 | | 2 | TOMBALAKIAN, STEVEN R & MARIA 25 KNOLLWOOD AVE MADISON, NJ 07940 | 25 KNOLLWOOD AVE | |
| 908 | 7 | | 2 | CROWDER, CARL G III & NANON 29 KNOLLWOOD AVE MADISON, NJ 07940 | 29 KNOLLWOOD AVE | |
| 908 | 8 | | 2 | STERN, KELLY A 31 KNOLLWOOD AVE MADISON, NJ 07940 | 31 KNOLLWOOD AVE | |
| 908 | 9 | | 2 | KAYE, WILLIAM & MARILEE T 33 KNOLLWOOD AVE MADISON, NJ 07940 | 33 KNOLLWOOD AVE | |
| 908 | 10 | | 2 | EMMITT, ALICE & TREVOR 35 KNOLLWOOD AVE MADISON, NJ 07940 | 35 KNOLLWOOD AVE | |
| 908 | 11 | | 2 | BRIGGS, WILLIAM J & JULIA P 37 KNOLLWOOD AVE MADISON, NJ 07940 | 37 KNOLLWOOD AVE | |
| 908 | 12 | | 2 | O'BRIEN, THOMAS HENRY III & LAURIANN 39 KNOLLWOOD AVE MADISON, NJ 07940 | 39 KNOLLWOOD AVE | |
| 908 | 19 | | 2 | LONDON, JOSHUA & POLETTA, VALENTINA 38 VALLEY RD MADISON, NJ 07940 | 38 VALLEY RD | |
| 908 | 20 | | 2 | COFFEY, MICHAEL J/VALERIE E 34 VALLEY RD MADISON, NJ 07940 | 34 VALLEY RD | |
| 908 | 21 | | 2 | DELACRUZ, PAUL & MCINTYRE, CHRISTINE 32 VALLEY RD MADISON, NJ 07940 | 32 VALLEY RD | |
| 908 | 22 | | 2 | WEXLER, TODD & VALERIE GOMEZ 28 VALLEY RD MADISON, NJ 07940 | 28 VALLEY RD | |
| 908 | 23 | | 2 | XU, BO & MA, QIANG 26 VALLEY RD MADISON, NJ 07940 | 26 VALLEY RD | |

REQUEST FOR 200' LIST

**\$10.00 FEE-PAYABLE TO:
THE BOROUGH OF MADISON**

THIS LIST IS VALID FOR 60 DAYS ONLY

N.J.S. 40:55D-12c provides that, upon written request of an applicant, the "administrative officer" of a municipality shall, **within SEVEN DAYS**, make and certify a list from the current tax duplicate of names and addresses of owners to whom the applicant is required to give notice.

NAME: DANA NAPURANO, AIA - HOFMANN DESIGN BUILD

ADDRESS: 30 KNOLLWOOD AVENUE

BLOCK: 905 LOT: 17

PHONE NUMBER: 908-267-7850

DATE REQUESTED: 1/18/23

EMAIL: DANACHOFMANNDDB.COM

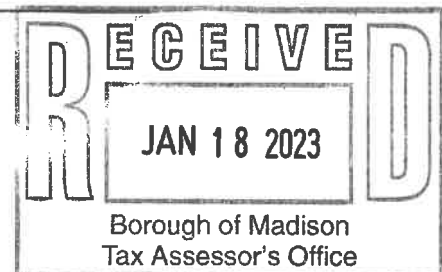

pd
\$10.00
cash
js